

# Contents

## 1-2. Proper use and operation

### 1. General Information

1-1. Introduction	2
1-2. Proper use and operation	3
1-3. Safety notes	3

### 2. Contents

2-1. Accessory included	4
2-2. Name of parts	5

### 3. Operating Instruction

3-1. Connection diagram	6
-------------------------	---

### 4. Functional description

4-1. Searching the satellite	7
4-2. Back to HOME position & Turning off	7
4-3. Special function	8

### 5. Software Upgrade

### 6. Troubleshooting

### 7. Specifications

7-1. Dimension	12
7-2. Specifications	12

### 8. Caravan/Motorhome Installation

8-1. Required space for SNIPE3	13
8-2. Equipment for installation	14
8-3. Instruction for installation	14

# 1. General Information

## 1-1. Introduction

These instructions describe the functions and operation of SNIPE3, auto skew satellite system. Correct and safe operation of the system can only be ensured by following instruction, both for installation and operation.

SNIPE3 is an intelligent satellite-TV reception system which can align itself towards a preset satellite automatically as long as the system is located within the footprint of the selected satellite.

SNIPE3 only occupies requisite space while it performs the necessary adjustments with slim and agile antenna body.

For general operation, please ensure that the system always has a clear view to the sky. In Europe, all satellites are in an approximate position on the equator. If the satellite's signal beam is interrupted by obstacles such as mountains, buildings or trees, the unit will not function and no TV signal will be received.

For more information on general use of this unit consult local dealer for assistance.

## 1-2. Proper use and operation

This product has been designed for portable use and fixed installation on vehicles with maximum speeds of 130 km/h. The unit is programmed to automatically aims at geostationary television satellites.

The power is supplied by a standard vehicle electrical system with a rated voltage of 12 Volts DC. For installations on the vehicle, use power input cable (cigarette lighter adaptor) to supply power. For portable use, optional power adaptor produced by SNIPE3 manufacturer must be used.

Use of the equipment for any other purpose to the one specified is not permitted.

### Please also note the following instructions from the manufacturer :

- It is not possible to add or remove components on this product.
- The use of other components other than those originally supplied is not permitted.
- To complete installation, installer must strictly follow instruction in the supplied user manual. Failure to follow the user manual may cause damage to the unit or user's vehicle.
- The product does not require any regular maintenance; all service must be carried out at approved service centers.
- All relevant guidelines of the automotive industry must be observed and complied with.
- The equipment must only be installed on solid vehicle roofs.
- Avoid cleaning user's vehicle with the mounted satellite system in a drive-through car wash or a car wash with a high-pressure cleaner.

## 1-3. Safety notes

Please carefully read and follow the operating instructions in this manual and use the SNIPE3 for its intended purpose.

Upon installation of SNIPE3, please ensure the installation is done with supplied cables and ensure the cables are not modified in any way.

As the user of this equipment, be responsible for ensuring compliance with the relevant laws and regulations.

The manufacturer does not take liability for direct or indirect consequential damage of the system, motor vehicles or other equipment by reason of unsuitable battery usage or erroneous installation or wrong wire connection.



## 2. Contents

### 2-1. Accessory included

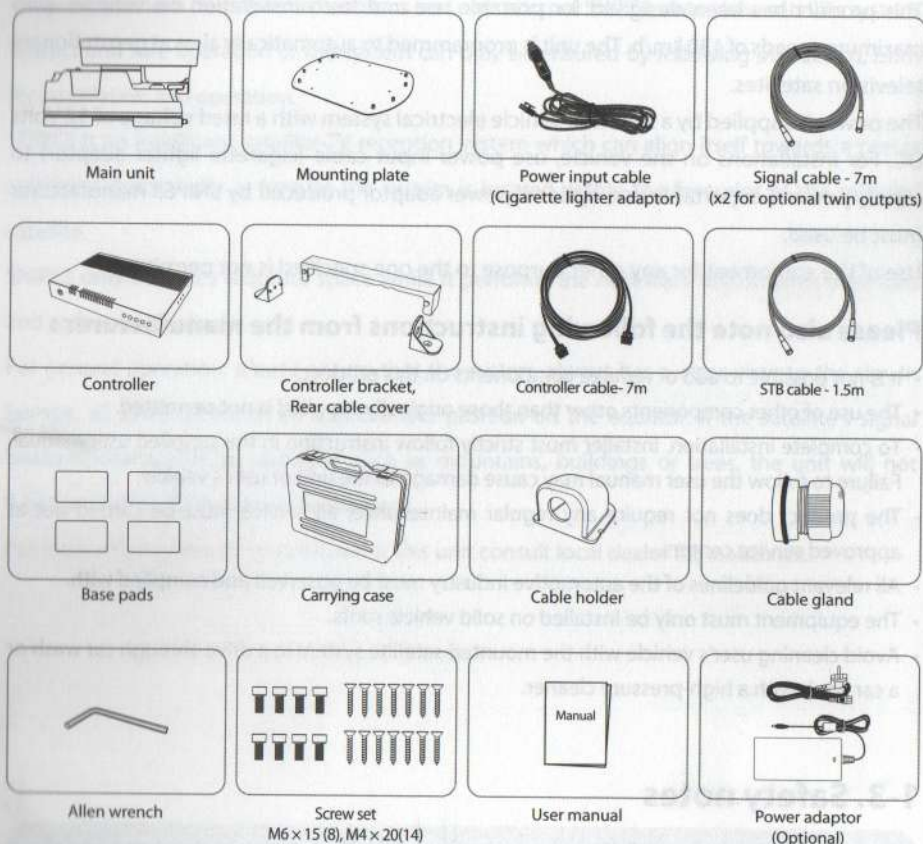

- ❗ Power adaptor has to be purchased separate. Please ask to local dealer/shop for more information.
- ❗ Only power adaptor produced by SNIPE series manufacturer is guaranteed and has to be used.
- ❗ Actual components may differ from the above images.
- ❗ The unit enables to have power from car battery. To make power input cable for direct connection, cut off cigarette lighter adaptor and peel off to take copper cables out.

### 2-2. Name of parts

#### Main unit

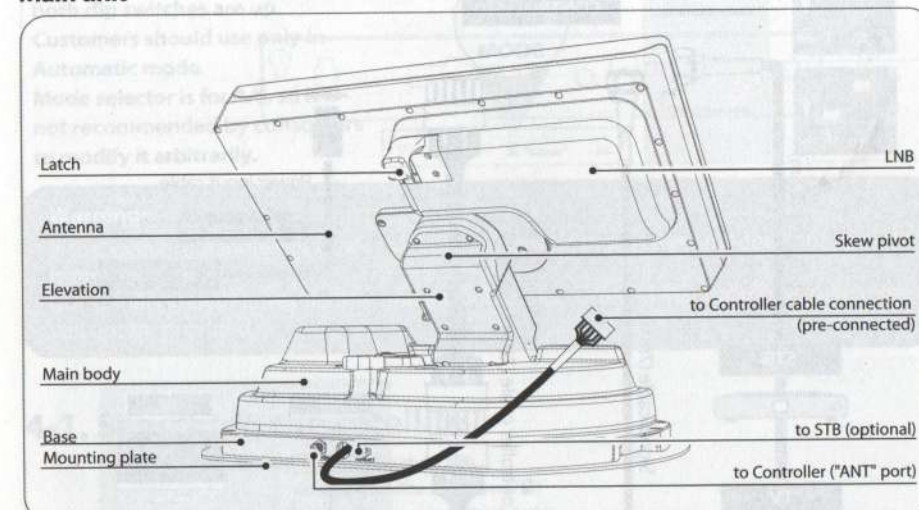

#### Controller

##### • Front

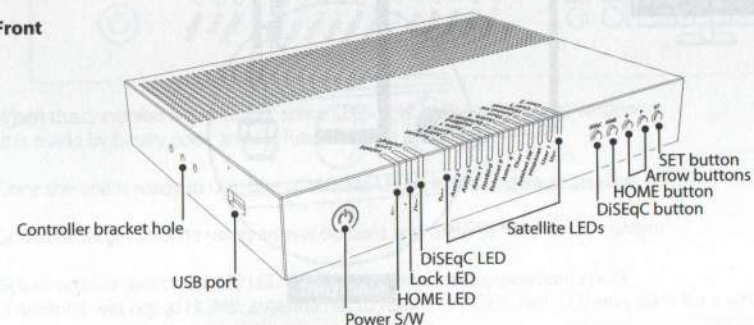

#### LED Indicator

On Off Blinking

##### • Back

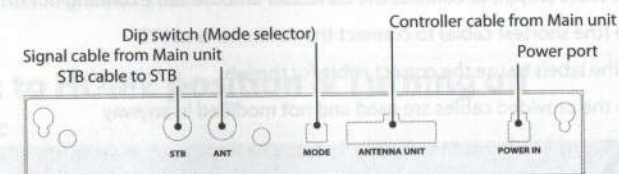

Note : For normal operation, Dip switches in MODE should be up



### 3. Operating Instruction

#### 3-1. Connection diagram

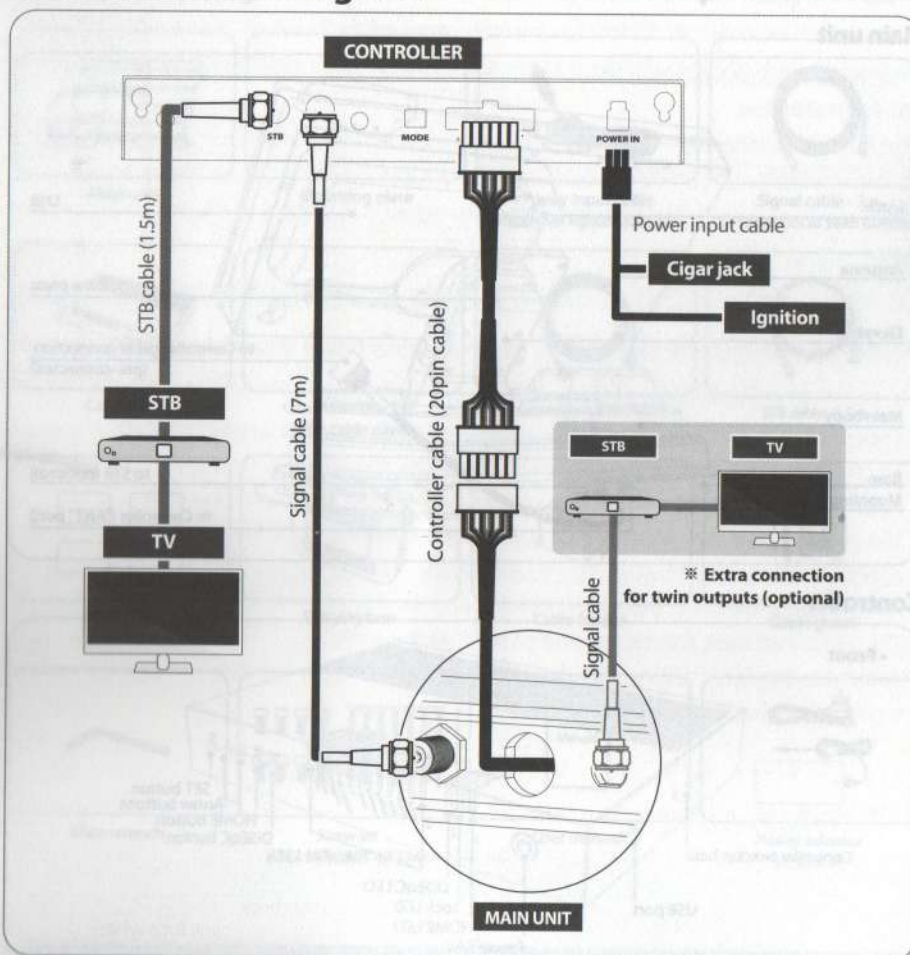

- There are two cable connections from the main unit to the controller
- Use controller cable (20pin) to connect the controller and the cable running out from the main unit
- Use STB cable (the shortest cable) to connect the controller and STB
- Please check the labels to use the correct cable for the job
- Please ensure the provided cables are used and not modified in anyway



#### Portable use

Attach four(4) base pads to the bottom of antenna base.

### 4. Functional description

#### ※ Get ready to use

Default is set Automatic mode;  
both dip switches are up.

Customers should use only in  
Automatic mode.

Mode selector is for A/S, so it is  
not recommended by consumers  
to modify it arbitrarily.

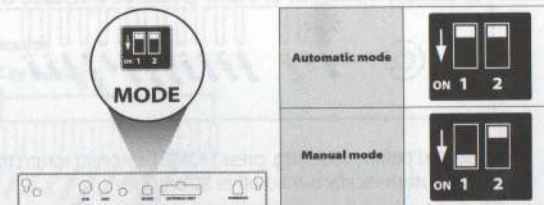

#### Warning

If the switch is handled in other than the Automatic mode, the unit does not operate normally.  
Consumers should never do this, and if trouble is occurred in Manual mode, guarantee will not be provided.

#### 4-1. Searching the satellite

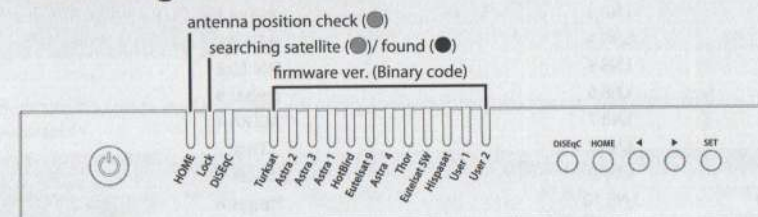

- When the controller is turned on, some LEDs light indicate firmware version (It is made by binary code and for future service purpose)
- Once the unit is ready to use, one of satellite LED is lit ON at default satellite
- Go to the target satellite using arrows buttons and press SET button to confirm
- Before satellite search, HOME LED blinks for antenna status(position) check (If antenna was not at HOME, antenna has to return to HOME first, LED may blink for a while)
- Lock LED blinks during satellite search and becomes solid when the target satellite is found
- After use and before travelling, press HOME button for HOME positioning

#### 4-2. Back to HOME position & Turning off

##### A. Automatic

In some cases, the antenna is automatically stopped and sent to HOME position

- If vehicle drives 25km/h or higher for 20 seconds
- If ignition cable is connected and ignition signal is detected



## B. Manual

After use and before travelling, the antenna has to be sent to HOME manually

For example :

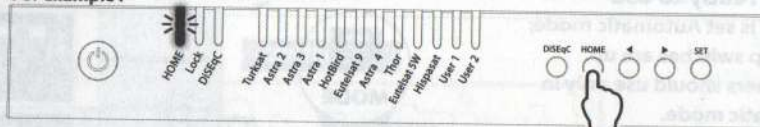

- After use and before travelling, press HOME button to return the antenna back to HOME position and the unit is automatically turned off in 30 seconds
- HOME LED blinks during HOME positioning and becomes solid when the antenna is at HOME

## 4-3. Special function

### A. DiSEqC setting

Refer SNIPe3's pre-satellites for DiSEqC 1.1 when user setup at STB

NO	LNB	Satellite
1	LNB 1	Turksat
2	LNB 2	ASTRA2
3	LNB 3	ASTRA3
4	LNB 4	ASTRA1
5	LNB 5	Hot Bird
6	LNB 6	Eutelsat 9
7	LNB 7	ASTRA 4
8	LNB 8	Thor
9	LNB 9	Eutelsat 5W
10	LNB 10	Hispasat
11	LNB 11	USER1
12	LNB 12	USER2

- Default setting for DiSEqC is OFF, DiSEqC LED is off

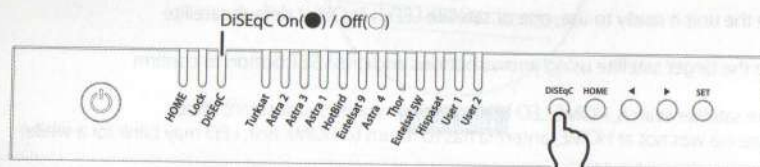

- To switch the function ON/OFF, make sure that antenna is at HOME and press DiSEqC button for DiSEqC can be executed after pressing 2 seconds (See also DiSEqC LED status changes between ON and OFF)
- For DiSEqC operating, user needs to assign DiSEqC satellites list at STB is in same order as above SNIPe3's pre-set list

### NOTE

When antenna is not at HOME position, press SET button to activate DiSEqC function

## B. GPS location manual setting

In case, antenna takes long time to search a satellite, there is the extra option of location setting for GPS.

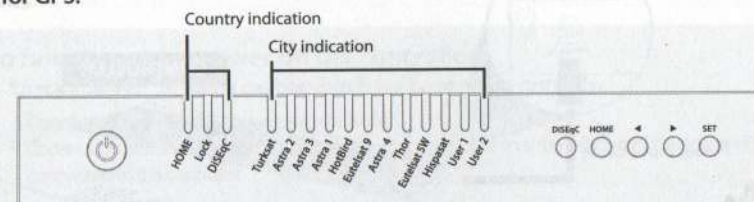

- Press and hold DiSEqC button then turn on the controller
- Select the country from available options (four(4) countries) using DiSEqC/HOME buttons to change and confirm with controller LED ON as below table

Country	HOME LED	Lock LED	DiSEqC LED
Germany		All LED OFF	
France	ON	-	-
Netherland	-	ON	-
Italy	-	-	ON

- Select the city from available options using arrow buttons to change and confirm with LED ON as below table

	Germany	France	Netherland	Italy
Turksat	Aachen	Bayonne	Alkmar	Barletta
ASTRA2	Augsburg	Brest	Apeldoorn	Bolzano
ASTRA3	Bad Homburg	Caen	Enschede	Cagliari
ASTRA1	Bamberg	Calais	Groningen	Carpi
Hot Bird	Berlin	Colmar	Hoogeveen	Catania
Eutelsat 9	Chemnitz	Nantes	Leeuwarden	Lecce
ASTRA 4	Göttingen	Nizza	Nijmegen	Livorno
Thor	Hamburg	Paris	Roermond	Milano
Eutelsat 5W	Münster	Saint-Étienne	Rotterdam	Napoli
Hispasat	Offenburg	Dijon	Tilburg	Pesaro
USER1	Passau	Toulouse	Utrecht	Pescara
USER	Neubrandenburg	Limoges	Emmeloord	Roma

- Once location setting is finished, press SET button to save
- LEDs become off and controller will be automatically turned off
- At next turn on, the antenna finds satellite with saved information

### NOTE

GPS location manual setting is an option for instant satellite search, the antenna will search satellite based on GPS data after GPS is received



## 5. Software Upgrade

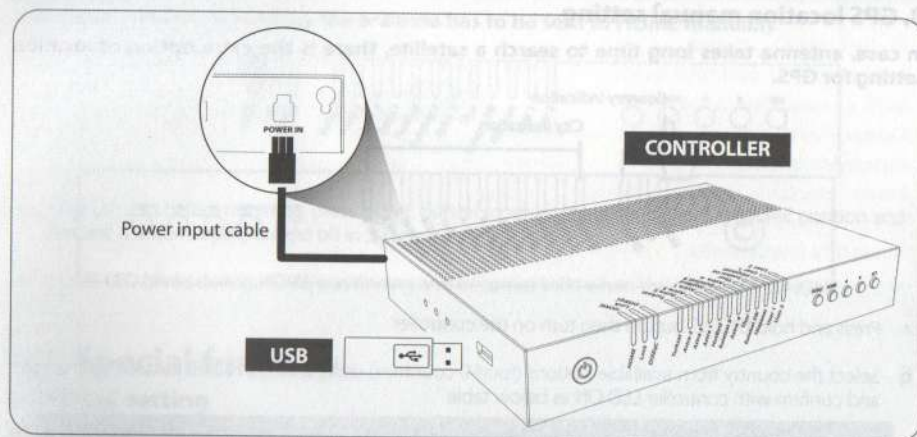

### NOTE

- ※ USB 2.0 standard has to be only used for upgrade
- ※ Use FAT32 format USB only

1. Transfer software program to a USB root folder (not belonging to any other folder) in an empty USB
  - i. Please go to website [www.selfsat.com](http://www.selfsat.com) to download upgrade program (software)
  - ii. In case a controller does not recognize the USB drive, take the USB out and plug into a PC. Right click USB folder, go to "Properties" and check if the "File system" is FAT32. If not, right click USB folder again, go to "Format" and re-setup a file system to FAT32
2. Ensure that the unit is turned off and plug the USB into USB port of controller
3. Press and hold SET button then turn on the power
4. During upgrade process, satellite LEDs are lit in sequence

#### For example :

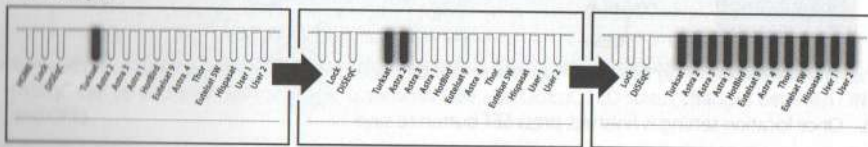

5. Once upgrade is completed, controller starts to reboot

## 6. Troubleshooting

There are a number of common issues that can affect the signal reception quality or the operation of the unit. The following sections address these issues and potential solutions

### A. No function when power on the controller

- i. Check again all the cable connections have been made correctly.
  - Connection between the power and controller.
  - Connection between the controller and antenna. Make sure that the left port of the antenna should be connected to the controller.
- ii. Check if the power input cable has been damaged.
- iii. Check the battery polarities (+/-).

### B. Fail to search the selected satellite

- i. Satellite signals can be blocked or degraded by buildings, trees. Make sure there are no obstructions in a southward direction.
- ii. Select another satellite as example Astra3, if this locks then select your desired satellite.
- iii. Turn the unit off and then back on again and select desired satellite.

### C. Mechanical problems

- i. If the antenna does not move into desired position.
  - Try to power OFF/ON again.
- ii. If the antenna makes a noise whilst remaining static.
  - Try to power OFF/ON again. If problem persists, please contact local dealer/shop for assistance.

### D. Other issues

- i. If the system has been improperly wired, it will not operate properly. Contact local dealer/shop for assistance of cable damage.



## 7. Specifications

### 7-1. Dimension

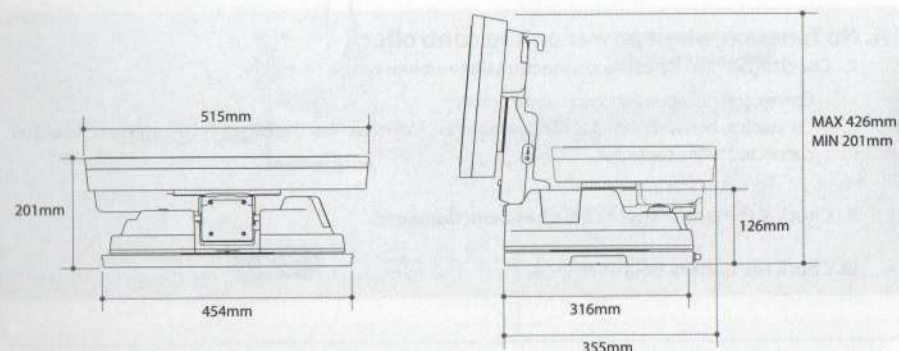

### 7-2. Specifications

Input Satellite Frequency	10.7 ~ 12.75 GHz
Polarization	Vertical & Horizontal
Antenna Gain	33.7 dBi @ 12.7 GHz
Size (W x D x H)	515 x 355 x 201 mm
Weight	10.3 kg
Min EIRP	50 dBW
Angle Range (Elevation, Azimuth, Skew)	15° ~ 90°, 360°, -45° ~ +45°
Satellite Searching Time	120 seconds (AVG)
Output	1 / 2 output (Optional)
LNB Output Frequency	950 ~ 2,150 MHz
L.O. Frequency	9.75 / 10.6 GHz
Operating Temperature	-30 °C ~ +60 °C
Input Voltage	DC 12 V
Power Consumption	30 W (in searching)

## 8. Caravan/Motorhome Installation

### 8-1. Required space for SNIEP3

Please allow that there is enough space around SNIEP3 for flat antenna section to complete a full 360° scan of the sky and return to the HOME position

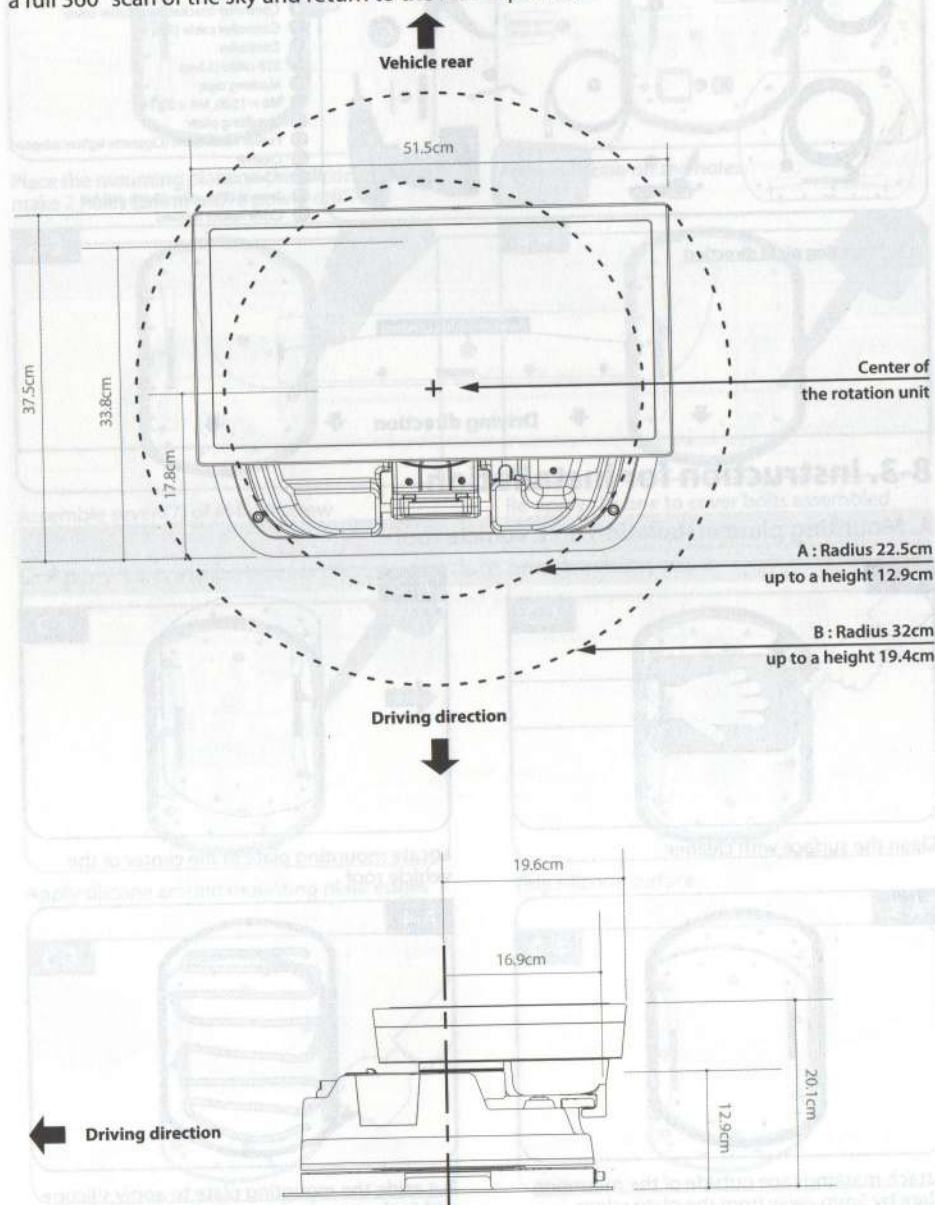



## 8-2. Equipment for installation

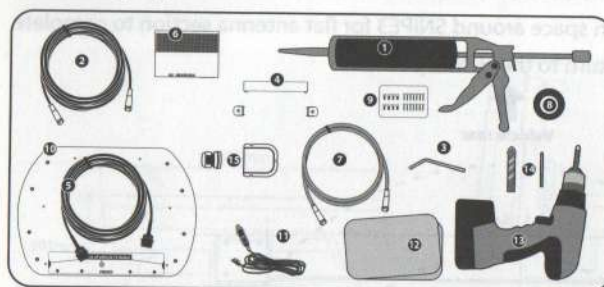

- 1 Silicone
- 2 Signal cable (7m)
- 3 Allen wrench
- 4 Controller bracket, Rear cable cover
- 5 Controller cable (7m)
- 6 Controller
- 7 STB cable (1.5m)
- 8 Masking tape
- 9 M6 x 15(8), M4 x 20(14)
- 10 Mounting plate
- 11 Power input cable (Cigarette lighter adaptor)
- 12 Cleaner
- 13 Power drill
- 14 2mm drill bit, over 25mm drill bit
- 15 Cable holder & gland

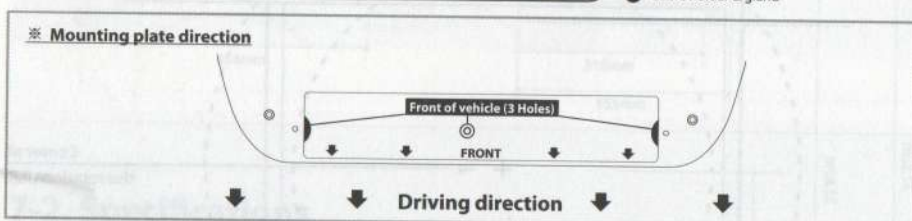

## 8-3. Instruction for installation

### A. Mounting plate installation on a vehicle roof

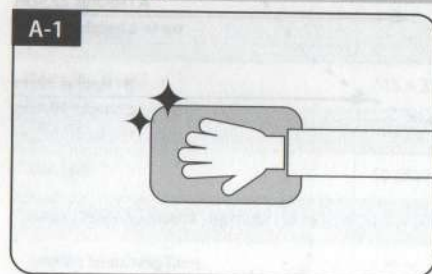

Clean the surface with cleaner

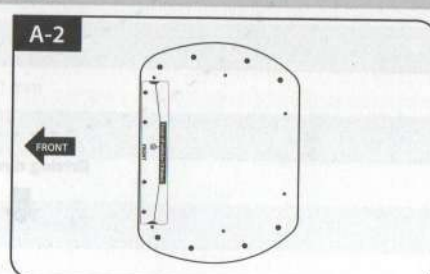

Locate mounting plate in the center of the vehicle roof

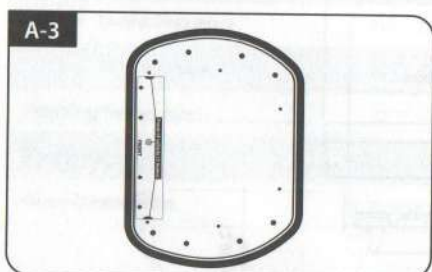

Attach masking tape outside of the mounting plate by 5mm away from the plate edges

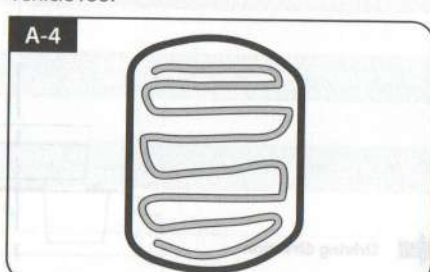

Put aside the mounting plate to apply silicone within the attached tape line but leave 2cm inward gap from the line

### B. Assemble 7pcs of M4x20 bolt to fix the mounting plate

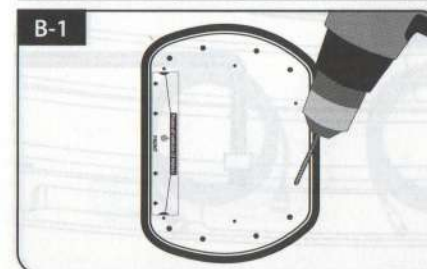

Place the mounting plate on the silicone and make 7 holes (2mm) with a power drill

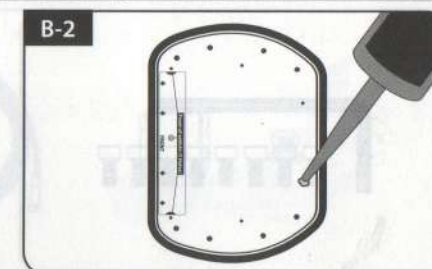

Apply silicone on the holes

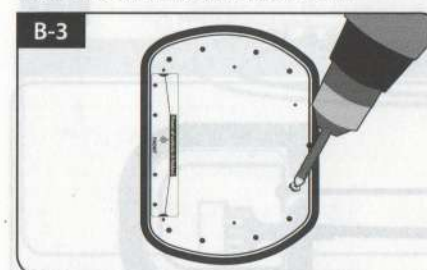

Assemble seven(7) of M4x20 screw

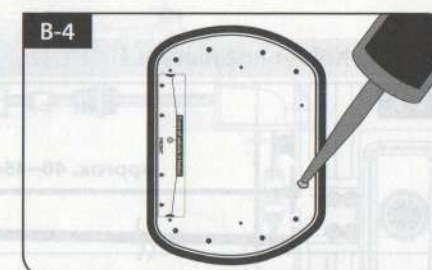

Re-apply silicone to cover bolts assembled

### C. Apply silicone between mounting plate and masking tape

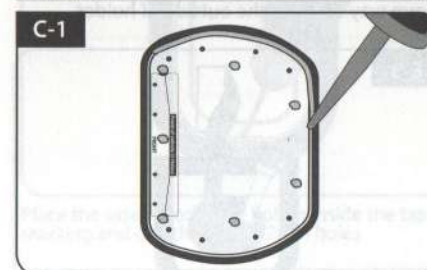

Apply silicone around mounting plate edges

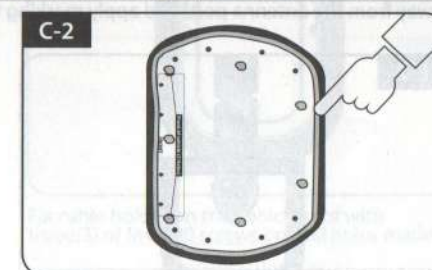

Tidy silicone surface

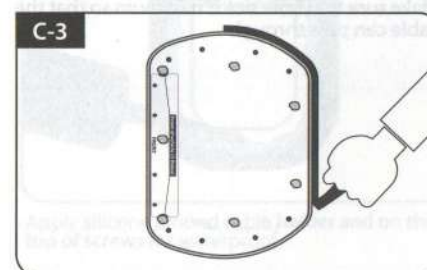

Remove masking tape and allow to dry

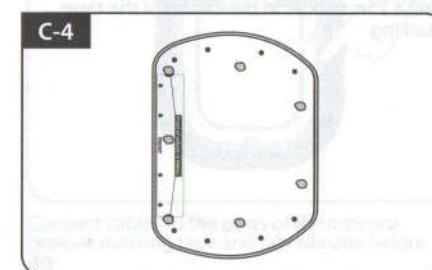

Prepare to place the antenna on to the upright bolts



#### D. Fix mounting plate with 8 pcs of M6x15 bolt using allen wrench

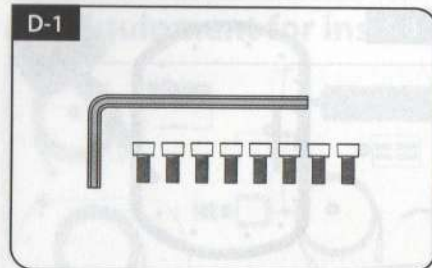

Parts required, allen wrench and eight(8) of M6x15 bolt

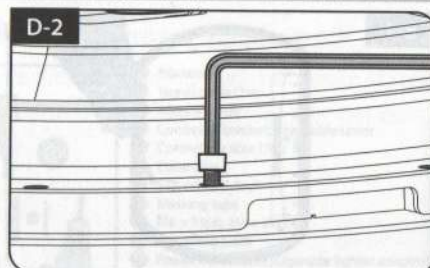

Place the antenna on mounting plate and tighten firmly each bolt by allen wrench

#### E. Cable holder installation 1

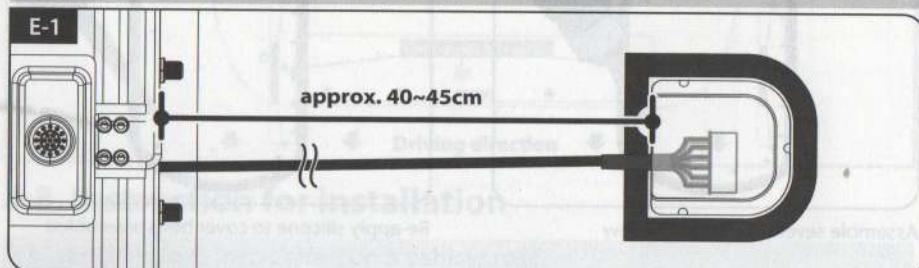

Place cable out from the antenna to have a rough idea of cable holder location (approx. 40~45cm away from the antenna port) and apply masking tape 5mm way off from the outside of holder



Drill a 25mm hole in the center of the tape marking



Make sure that hole size is minimum so that the cable can pass through

#### F. Cable holder installation 2

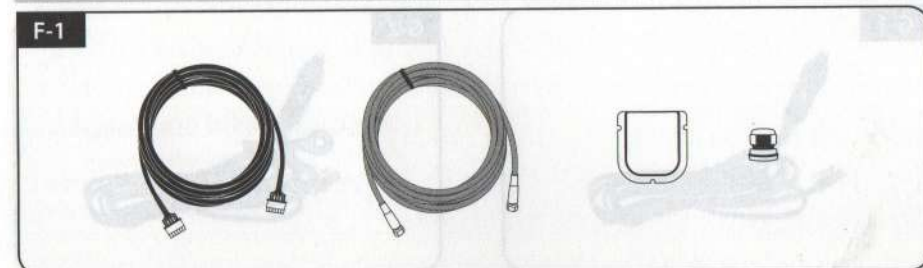

Signal cable, controller cable, cable holder and gland are required

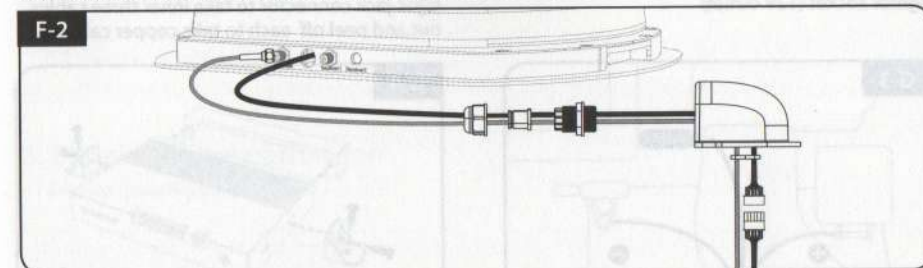

Set up required parts as above picture

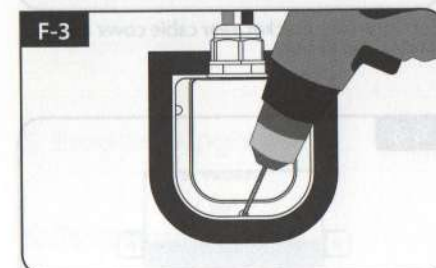

Place the assembled cable holder inside the tape marking and drill three(3) of 2mm holes

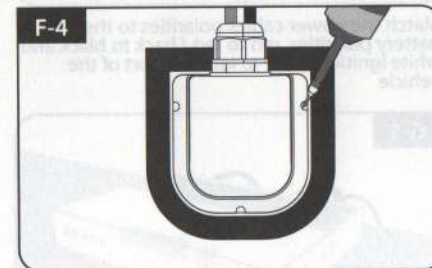

Fix cable holder on the vehicle roof with three(3) of M4 x 20 screws on drill holes made

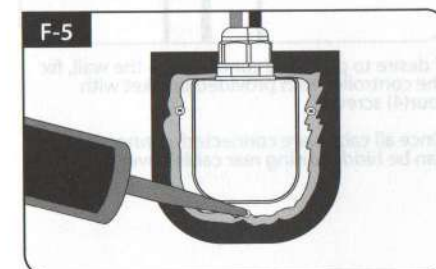

Apply silicone around cable holder and on the top of screws for waterproof



Connect cables to the ports of the antenna, remove masking tape and tidy silicone before dry



## G. Controller installation

G-1



Get Power input cable and plug into cigar lighter socket (12V outlet)

G-2

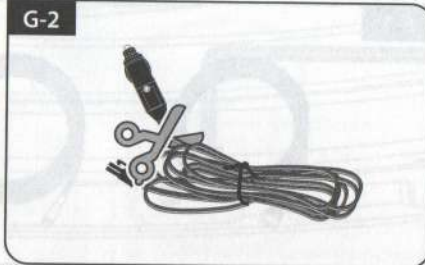

To source power from car battery, cut off cigar-jack connector to take inner three cables out and peel off each to take copper cable out

G-3

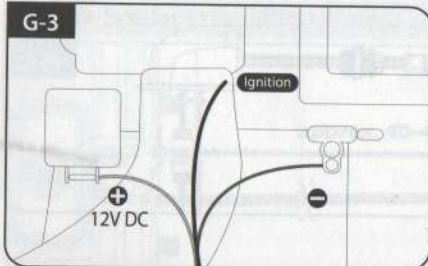

Match the power cables polarities to the battery polarities, red to red / back to black and white ignition cable to ignition port of the vehicle

G-4

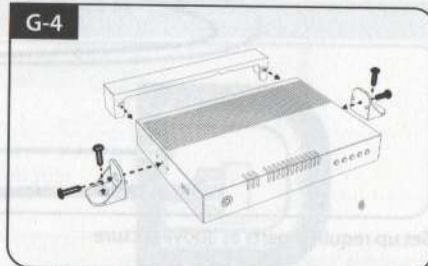

Get Controller bracket, rear cable cover and four(4) M4x20 bolt

G-5

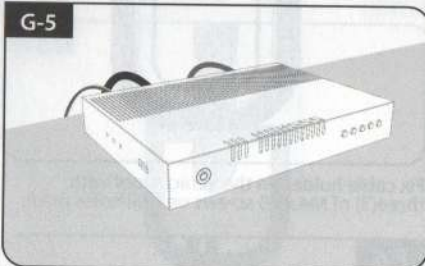

Place controller and plug the cables to the controller (Power, signal and controller cables)

G-6

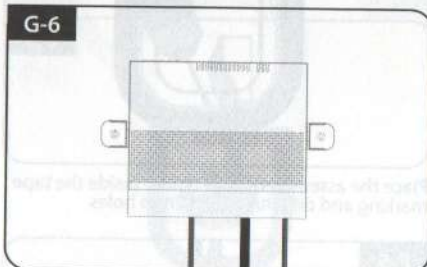

If desire to place the controller on the wall, fix the controller with provided bracket with four(4) screws

Once all cables are connected, connection part can be hidden using rear cable cover

## Inhaltsverzeichnis

### 1. Allgemeine Informationen

- 1-1. Produktvorstellung
- 1-2. Bestimmungsgemäße Verwendung
- 1-3. Sicherheitsanweisungen

### 2. Verpackungsinhalt

- 2-1. Lieferumfang
- 2-2. Teilebezeichnung

### 3. Bedienungsanweisungen

- 3-1. Anschlussdiagramm

### 4. Funktionsbeschreibung

- 4-1. Suche nach dem Satelliten
- 4-2. Zurück zu HOME Position und Ausschalten
- 4-3. Spezialfunktion

### 5. Program-Upgrade

### 6. Störungsbehebung

### 7. Technische Daten

- 7-1. Abmessungen
- 7-2. Technische Daten

### 8. Wohnwagen / Wohnmobil Installation

- 8-1. Vorbereitung für die Installation
- 8-2. Ausstattung für die Installation
- 8-3. Montage